

DEERFIELD TOWNSHIP SECTION 18 R13- TWP 9 MORGAN COUNTY, OH

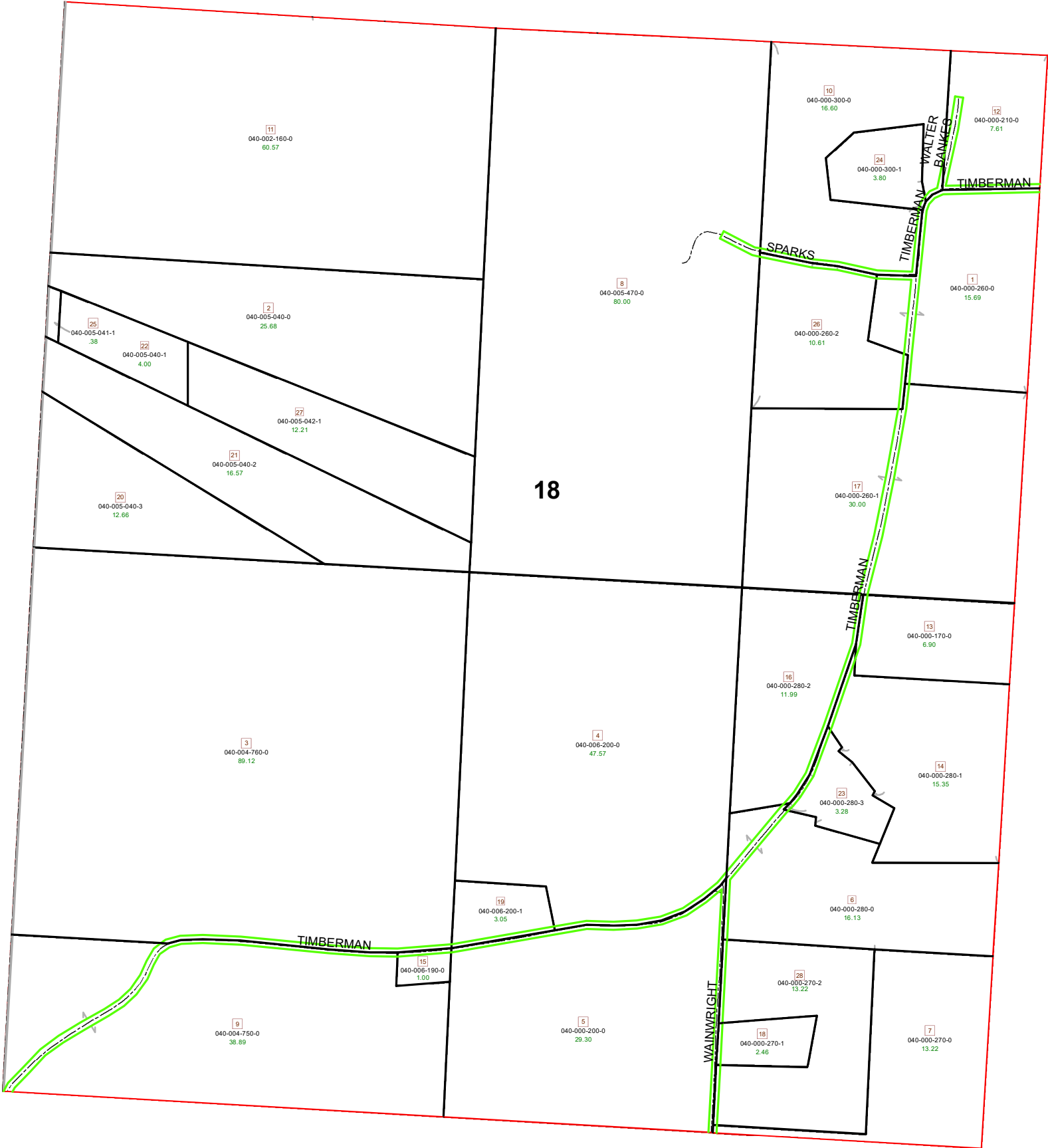

| PIN | VOL | PAGE | Owner | LegalDescr | Acres |
|---------------|---------|------|---------------------------------|---------------------|--------|
| 040-000-280-0 | OR229 | 197 | BANKES DANIEL L | R13 T09 S18 SD 6 | 16.13 |
| 040-000-280-3 | OR229 | 121 | BANKES DANIEL L | R13 T09 S18 SD 23 | 3.28 |
| 040-000-280-2 | OR226 | 1543 | BANKES DANIEL L | R13 T09 S18 SD 16 | 11.99 |
| 040-000-260-2 | OR200 | 71 | BANKES DANIEL L | R13 T09 S18 SD 26 | 10.61 |
| 040-000-270-2 | OR229 | 197 | BANKES DANIEL L | R13 T09 S18 SD 28 | 13.22 |
| 040-000-280-1 | D.V 185 | 94 | BANKES DAVID D & MURIEL | R13 T09 S18 SD 14 S | 15.35 |
| 040-000-260-1 | D.V 185 | 94 | BANKES DAVID D & MURIEL | R13 T09 S18 SURVIV | 30 |
| 040-000-170-0 | D.V 183 | 809 | BANKES DAVID D & MURIEL J | R13 T09 S18 SD 13 S | 6.9 |
| 040-000-200-0 | OR229 | 2591 | BANKES ROY E & LINDA D | R13 T09 S18 SD 5 EX | 29.3 |
| 040-000-210-0 | OR229 | 1407 | BANKES TAMERA J | R13 T09 S18 SD 12 | 7.61 |
| 040-005-040-1 | OR24 | 489 | BATESON MITZI | R13 T09 S18 SD 22 | 4.014 |
| 040-000-270-1 | OR229 | 417 | CLAWSON CASEY & JANETTA | R13 T09 S18 SD 18 | 2.46 |
| 040-005-470-0 | OR117 | 606 | CLEMENS SAMUEL | R13 T09 S18 SD 8 | 80 |
| 040-000-260-0 | OR226 | 1539 | HALLOWELL ANNETTE R | R13 T09 S18 SD 1 | 15.69 |
| 040-000-300-1 | OR90 | 535 | HALLOWELL ANNETTE R | R13 T09 S18 SD 24 | 3.803 |
| 040-000-300-0 | OR226 | 1539 | HALLOWELL ANNETTE R | R13 T09 S18 SD 10 | 16.597 |
| 040-000-270-0 | OR229 | 204 | HORN DIANE E | R13 T09 S18 SD 7 | 13.22 |
| 040-005-040-3 | OR226 | 378 | MAURER FRANK & JOANNE | R13 T09 S18 SD 20 | 12.656 |
| 040-005-042-1 | OR220 | 48 | MAURER FRANK JR & JOANNE | R13 T09 S18 SD 27 | 12.21 |
| 040-005-041-1 | OR232 | 1726 | MAURER FRANK M & JOANNE C | R13 T09 S18 SD 25 | 0.38 |
| 040-005-040-0 | OR208 | 2880 | MAURER FRANK M & JOANNE C | R13 T09 S18 SD 2 SU | 25.68 |
| 040-002-160-0 | OR208 | 2880 | MAURER FRANK M & JOANNE C | R13 T09 S18 SD 11 E | 60.569 |
| 040-005-040-2 | OR179 | 735 | MCCLANNAN JACK L & E JOAN | R13 T09 S18 SD 21 S | 16.573 |
| 040-006-190-0 | OR229 | 63 | VALLEE LORI ANN | R13 T09 S18 SD 15 E | 1 |
| 040-004-750-0 | OR229 | 59 | WEAVER DAVID L & KAREN J HURST | R13 T09 S18 SD 9 EX | 38.888 |
| 040-004-760-0 | OR229 | 59 | WEAVER DAVID L & KAREN J HURST | R13 T09 S18 SD 3 EX | 89.12 |
| 040-006-200-1 | OR228 | 2668 | WEAVER ELI D | R13 T09 S18 SD 19 E | 3.046 |
| 040-006-200-0 | OR150 | 363 | WEAVER TIMOTHY J & WILLIAM TODD | R13 T09 S18 SD 4 EX | 47.574 |

Boundaries

| | |
|--------------------|----------------|
| ----- Future Split | ----- Parcel |
| ----- Hydro | ----- ROW |
| ----- County | ----- Section |
| ----- Lot | ----- Township |
| | ----- Symbols |
| | ----- Roads |

